

## Threaded bosses in castings\*

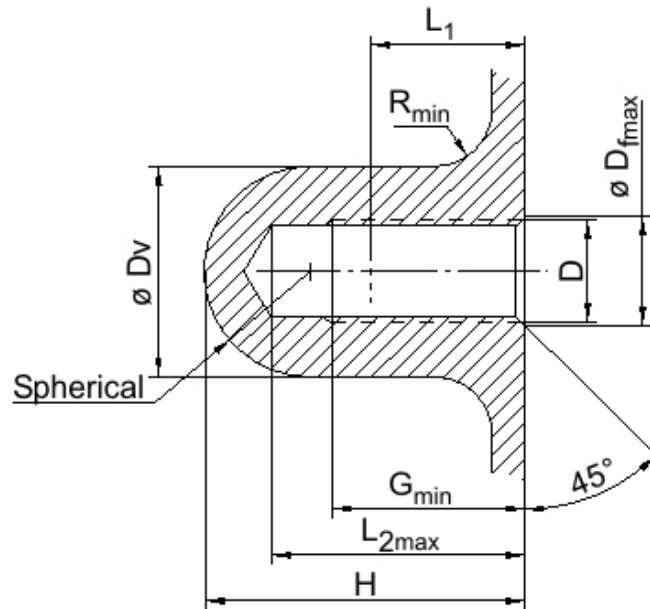

		Thread D									
		M4	M5	M6	M8	M10	M12	M14	M16	M20	M24
<b>Boss diameter</b>	<b>D<sub>v</sub></b>	12	14	16	20	24	27	30	33	39	45
<b>Radius</b>	<b>R</b>	5	5	5	5	6	7	8	9	10	11
<b>Chamfer diameter</b>	<b>D<sub>f</sub></b>	4,3	5,3	7	9	11	13	15	17	21	25
<b>Screwing-in length</b>	<b>L<sub>1</sub></b>	<b>G = Thread length    L<sub>2</sub> = Drilling (shoulder) depth    H = Boss height</b>									
<b>1 x D (Steel)</b>	<b>G</b>	6	7	9	11,5	14	16,5	19	22	27	32,5
	<b>L<sub>2</sub></b>	10	11,5	14	17,5	21,5	25	28,5	31,5	38	45,5
	<b>H</b>	15	19	20	24	29	34	38	42	51	60
<b>1.5 x D (Iron casting)</b>	<b>G</b>	8	9,5	12	15,5	19	22,5	26	30	38	45
	<b>L<sub>2</sub></b>	12	14	17	21,5	26,5	31	35,5	39,5	49	58
	<b>H</b>	17	20	23	28	34	40	45	50	62	73
<b>2 x D (Aluminium casting)</b>	<b>G</b>	10	12	15	19,5	24	28,5	33	38	47	56,5
	<b>L<sub>2</sub></b>	14	16,5	20	25,5	31,5	37	42,5	47,5	58	69,5
	<b>H</b>	19	22	26	32	39	46	52	58	71	84

Adopted by intREX CAD/CAM-Services (www.intrex.at) from various corporate standards.

\*Always use customer specifications, if available! For guidance only.